



SECURE &  
INDEPENDENT  
*...every step of the way*

# RouteGuardian Quick Start Guide



ROUTE  
GUARDIAN



# Welcome

## Your Account

Welcome to RouteGuardian, let's get you started. First you need to create your own personal RouteGuardian account. Beneath the LOG IN key you will see the prompt 'No account yet? Sign Up'.

Here at the sign-up screen you will need to provide:

- an email address (Your email is only used to send you notifications should you forget your password),
- create your own unique password (keep this safe, you will need this to log back into RouteGuardian should you log out at any point),
- As part of the safeguarding measures the 'Organisation code' provided to you by your school or local authority is entered here.

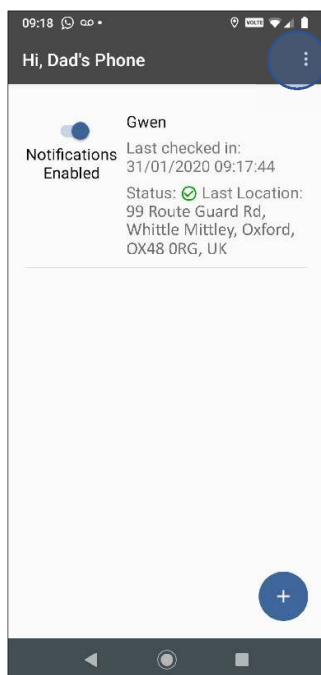
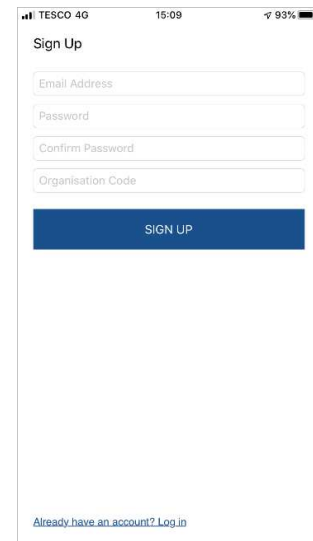

Now that you have created your account, you can make changes by tapping on these 3 dots here, allowing you to setup a Nickname and choose an account image. This is also where you logout.

**RouteGuard  
organisation  
code for Kings' is  
423-4310-PN**

## Pairing

To pair your phone with your child's phone they need to download the FREE RouteGuard app to their phone. To pair both devices first you need to simply click the '+' symbol here and create a Nickname or add your child's name. When you click invite a unique pairing code will be created which you can share using your normal messaging apps.

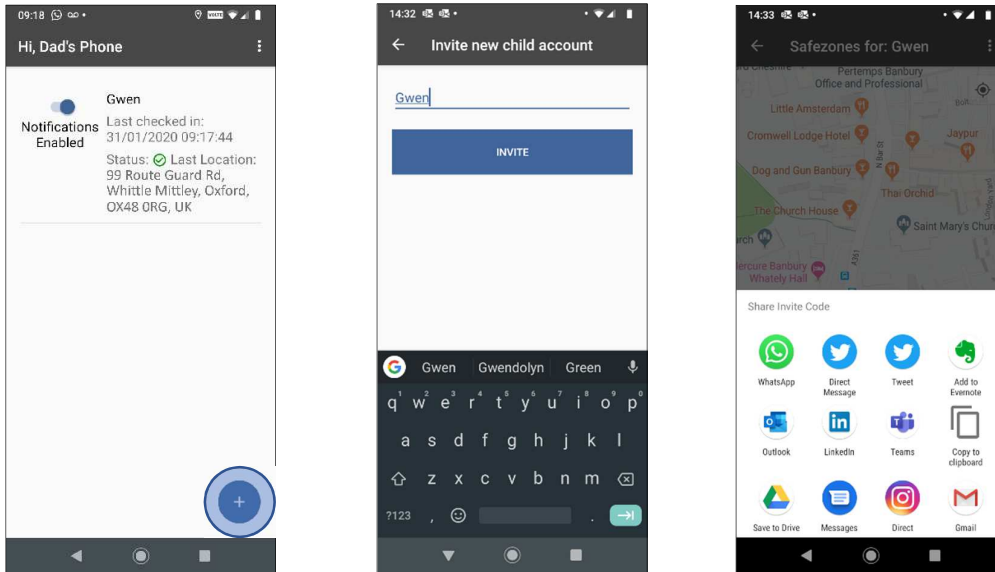

You can also choose a picture to associate with your child app<sup>1</sup>. You can invite your other children that have the RouteGuard app on their phones in the same way.

## Delete RouteGuard account

If you need to delete a Routeguard account, simply swipe it to the left to remove it.

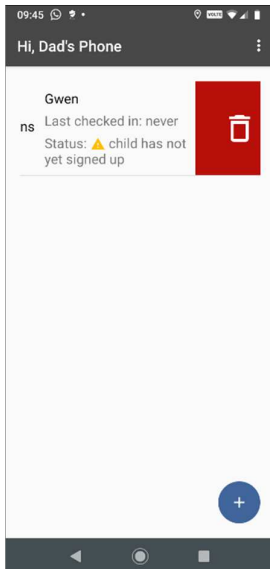

<sup>1</sup> Subject to development

## Creating zones

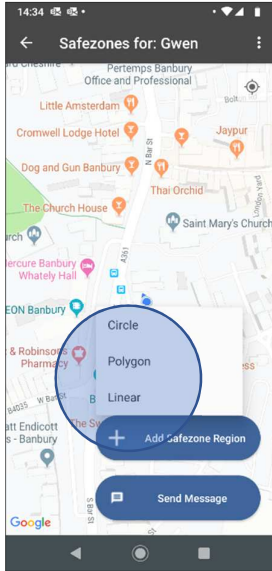

RouteGuard works by creating Safezones where you are happy for your young person to be. These can be created in 3 different ways. Circles, Lines or Freeform Shapes (Polygons).

When you select 'Circle', just click on the map and a circle will be created, you can adjust the size of it using the slider at the bottom of the map (10m up to 250m circumferences) followed by  to create the safezone.

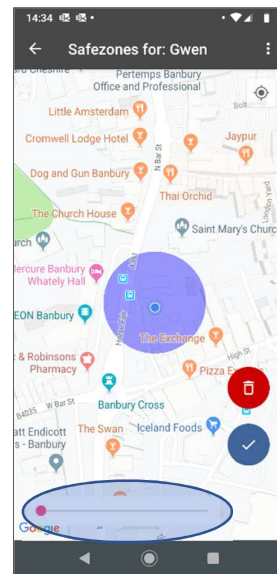

When you select 'Line' you can create a string of points, simply hit the tick mark to turn it into a route. These linear lines span 10meters wide and can be created using recognised highway or off road routes. This is helpful when creating home to school routes, after school routes to the child minder, to a friend or family's house or just simply to the shops.

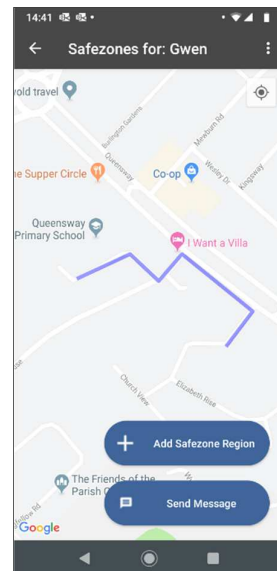
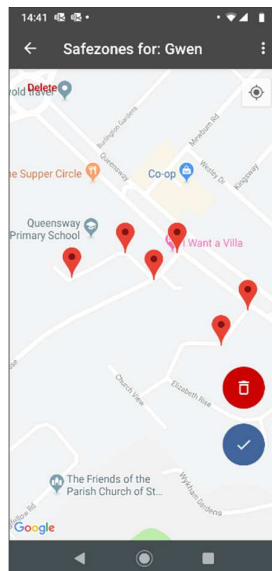

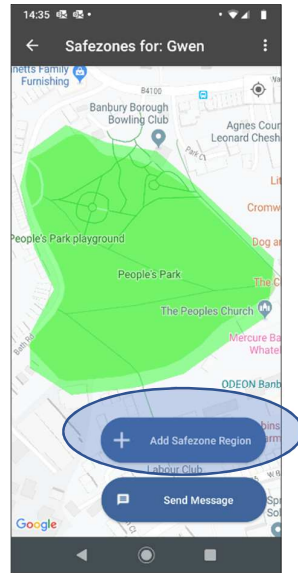
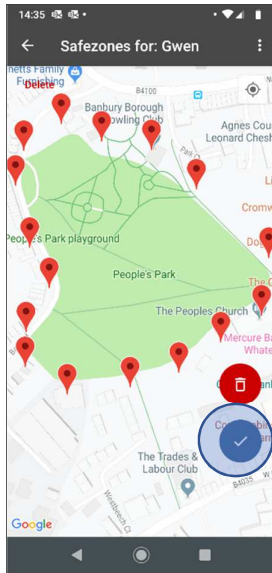

When you select 'polygon' you can draw a shape around an area and make it all into a safezone. Particularly helpful if you want to define a more specific area within a town or village ie skate park, village green or whole village or town area.

## Apply safezones to all accounts

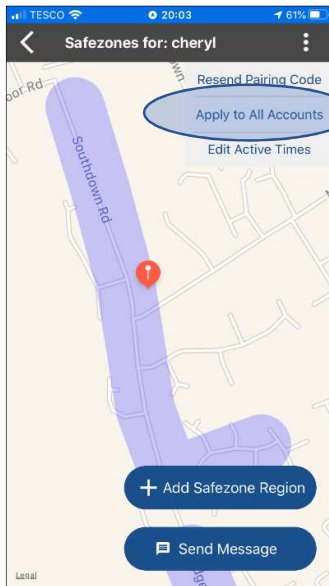

If you have created safezones that you want to use for all your RouteGuard accounts, click the 3 dots and select 'Apply Safezones to all child accounts'

## Deleting zones

If you need to delete any of the safezones created, click on the want you want to remove and tap the trash can.

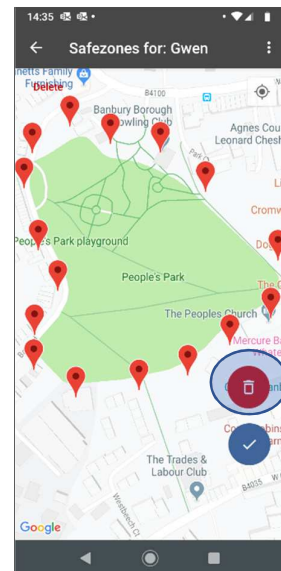



## Setting active zones

For RouteGuard accounts to be active you need to set some Active Times for each child, so click on 'Edit Active Times' and set the times during which you want RouteGuard to run. You can add multiply active times for each child relating to their independent walking or cycling activities.

For example –

- a home to school journey would be set based around the expected times they leave home to then arrive at school 08:15 to 09:00 Monday to Friday
- going to a friend's house and going to the park to play football, two safezones would be set the journey to the friend's house by selecting linear to define the route and using the polygon to define the park 15:00 to 18:00 Saturday

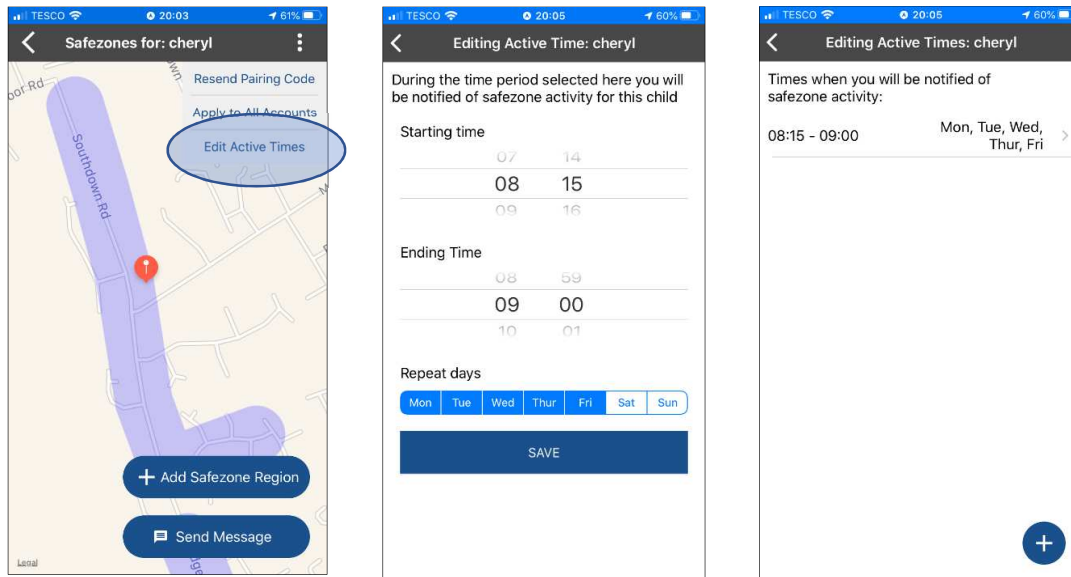

You will receive notifications during the active times you have set should your child leave the safezones you have created. If your child calls to request to change the agreed safezones (they want to pop and see another friend) you can add new safezones instantly. At any time you can see their last known location (see Location and messaging for more information).

## Turning Notifications on or off

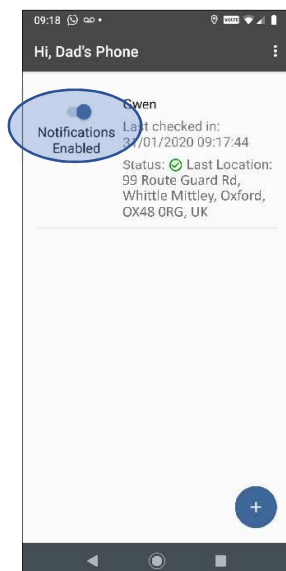

Sometimes travel arrangements change, so on the main screen, each individual account has a switch allowing you to turn notifications on or off.

## Location & Messaging

If you are unsure where your young person is, click on their account and it will take you to their last reported location. If they are not where you expected them to be, use the 'Send Message' button to contact them.

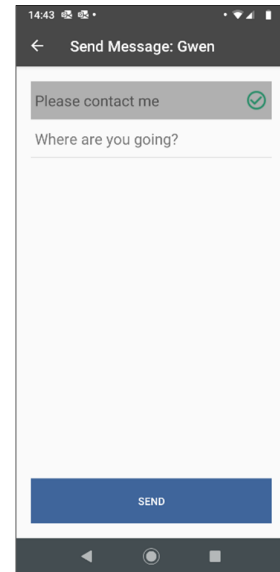

## Summary

All the above information can also be found in the RouteGuardian App itself, tap on the 3 dots and the Account tab, to access the help section ?

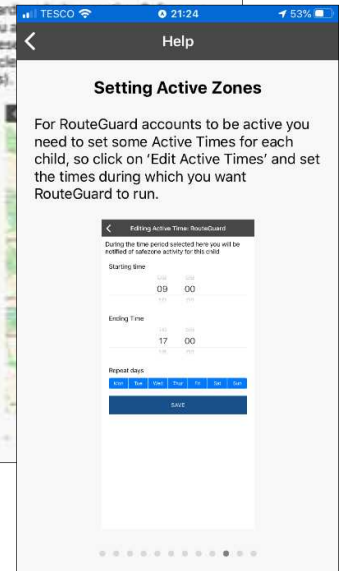
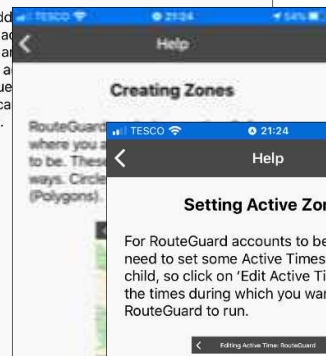
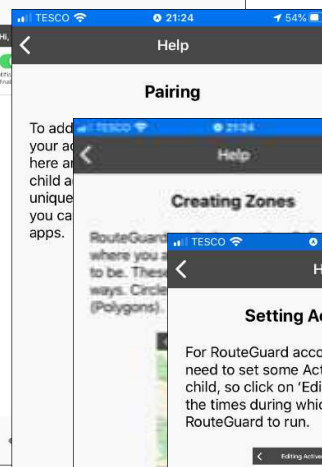
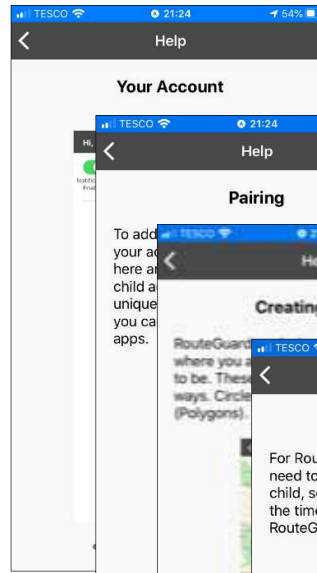
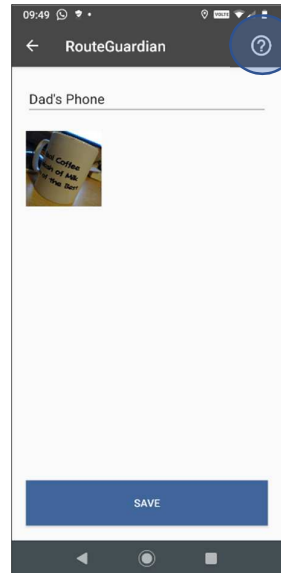

## Thank You for choosing RouteGuard

RouteGuard was developed to encourage more walking and cycling, to support both the young people who given the choice aspire to be more independent and parents who understandably want to ensure they are safe.

RouteGuard provides accessibility to Active travel and all its many benefits; Public Health England reports the following key messages<sup>2</sup>:

- physical inactivity directly contributes to 1 in 6 deaths in the UK and costs £7.4 billion a year to business and wider society
- the growth in road transport has been a major factor in reducing levels of physical activity and increasing obesity
- building walking or cycling into daily routines are the most effective ways to increase physical activity, health and wellbeing.

See RouteGuard as an opportunity to discuss travel choices and route planning, build trust with your child with the knowledge that although you are not physically with them you can locate their whereabouts at any time.

**SECURE & INDEPENDENT .....every step of the way**

[www.routeguard.co.uk](http://www.routeguard.co.uk)  
[info@routeguard.co.uk](mailto:info@routeguard.co.uk)

---

<sup>2</sup>[https://assets.publishing.service.gov.uk/government/uploads/system/uploads/attachment\\_data/file/523460/Working\\_Together\\_to\\_Promote\\_Active\\_Travel\\_A\\_briefing\\_for\\_local\\_authorities.pdf](https://assets.publishing.service.gov.uk/government/uploads/system/uploads/attachment_data/file/523460/Working_Together_to_Promote_Active_Travel_A_briefing_for_local_authorities.pdf)